



mach2tires.com

MACH II TIRE ASSEMBLY PARTS LIST		
ITEM NO.	DESCRIPTION	QUANTITY
1	PLASTIC TIRE 1/2	2
2	TRACTION PLATE	1
3	3/8"X3-3/4" BOLT	4
4	3/8" NUT	10 OR 12
5	3/8" WASHER	20 OR 24
6	3/8"x5" BOLT	6 OR 8
7	7/16" WASHER	1
8	7/16" NUT	1
9	RIM	1

ASSEMBLY INSTRUCTIONS

- A. TIGHTLY INSTALL TRACTION PLATE ON RIM.
- B. ASSEMBLE 2 TIRE 1/2'S AND RIM.
- C. INSTALL BOLTS,NUTS,WASHERS.
- D. EVENLY TIGHTEN BOLTS TO TORQUE.
- F. CUT OFF ALL 5" BOLTS[ITEM NO. 6] FLUSH TO NUT.

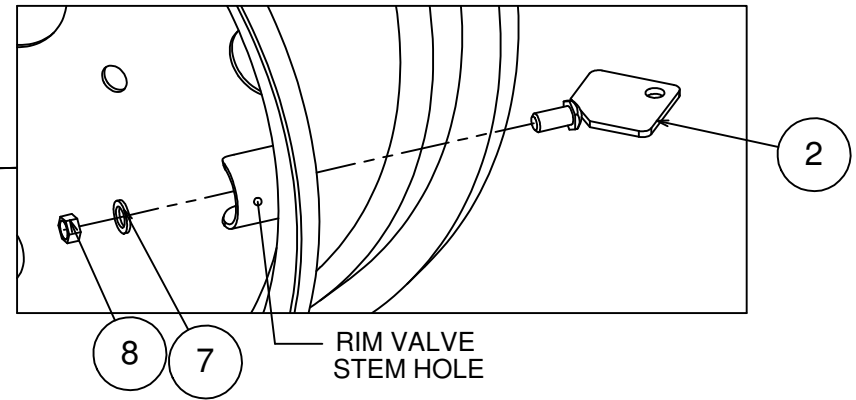
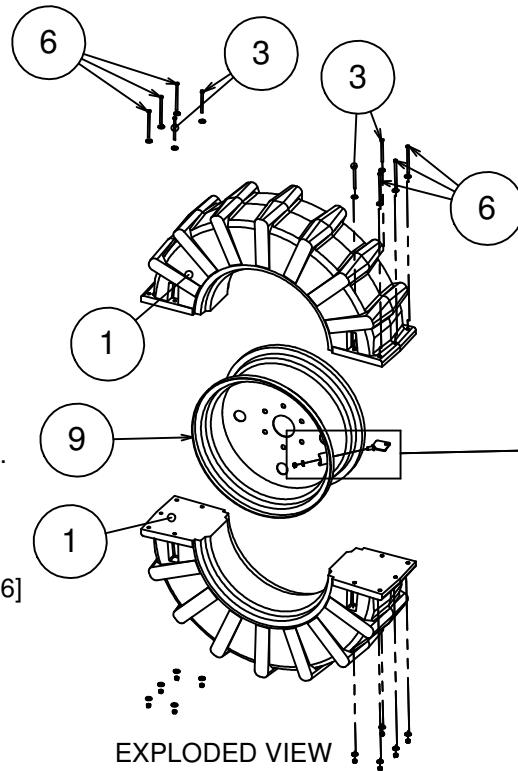

TIGHTEN ALL BOLTS TO 18 FT LBS OF TORQUE. GAP IS ACCEPTABLE WHEN TORQUE VALUE IS MET.

ACCEPTABLE GAP

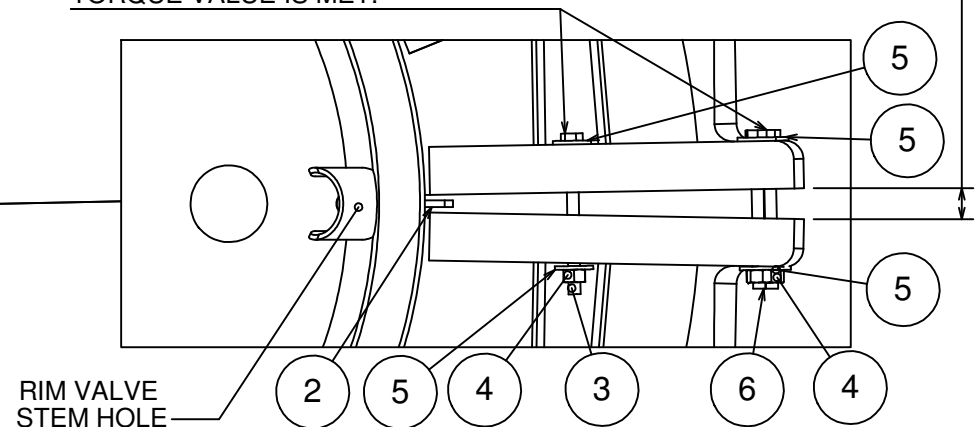
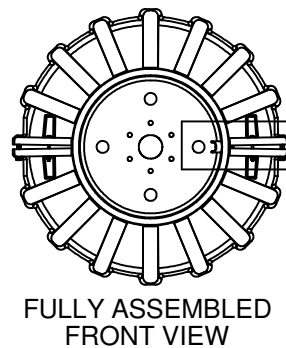

PLEASE NOTE:
In order to maintain the best level of traction, MACH II recommends checking and re-tightening all fasteners 30 days after first use, as seen on the website in the mounting link.